

Micro System

Terminals

TERM-LK

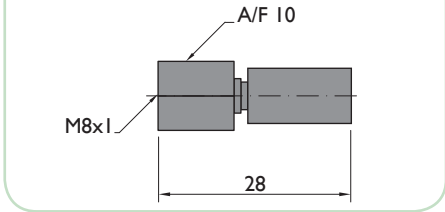

Hose to hose

RC-605

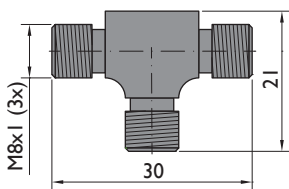

RC-606

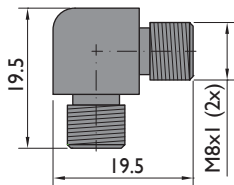

RC-607

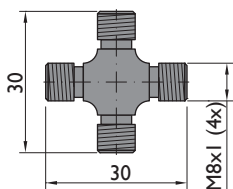

RM-609

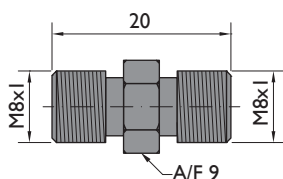

Couplings

RM-601

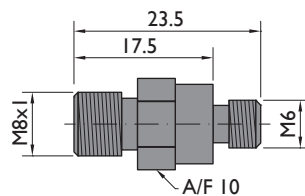

RM-602

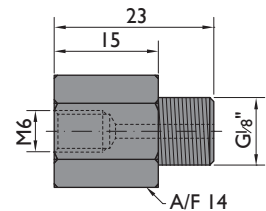

RM-603

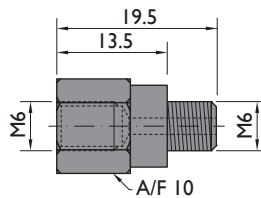

RM-604

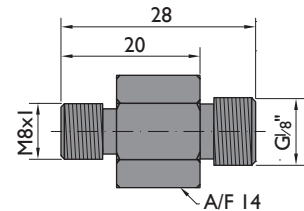

RM-605

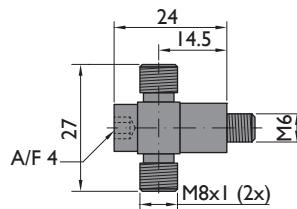

RM-606

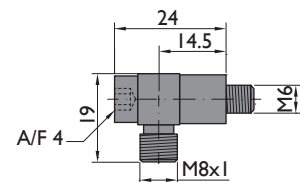

EO24 System

Terminals

TERM-LDR

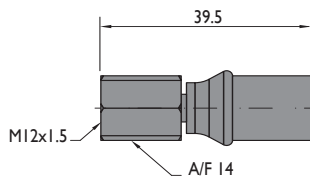

TERM-LDC

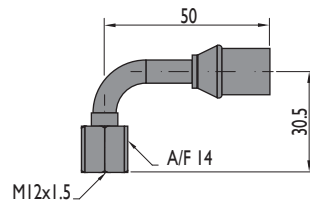

TERM-LDA

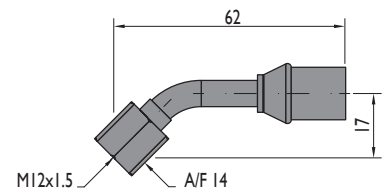

Hose to hose

RC-505

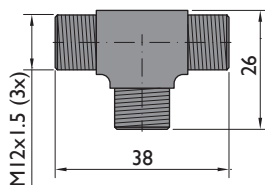

RC-506

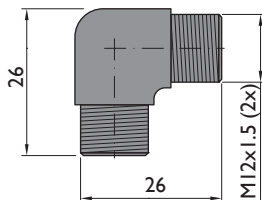

RC-507

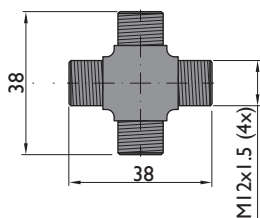

RM-509

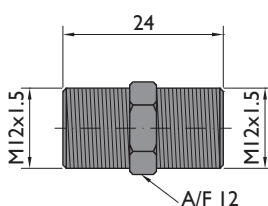

Couplings

RM-501

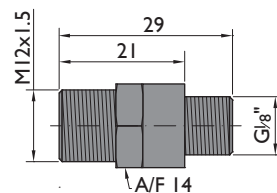

RM-503

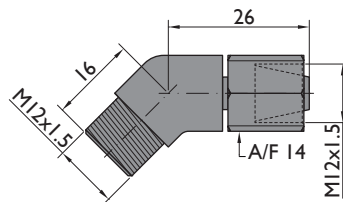

RM-504

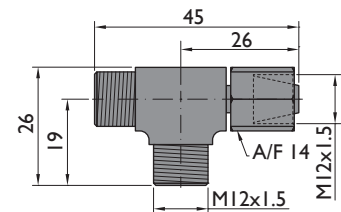

RM-505

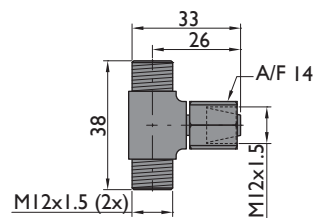

RM-506

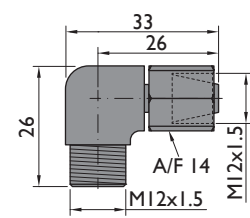

Minimess System

Terminals

TERM-RECTO

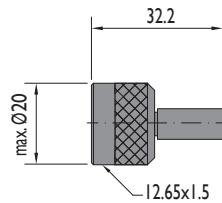

TERM-CODO

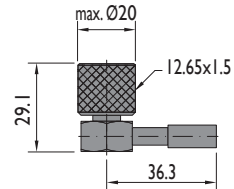

Hose to hose

RM-109

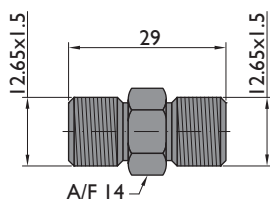

Couplings

RM-101*

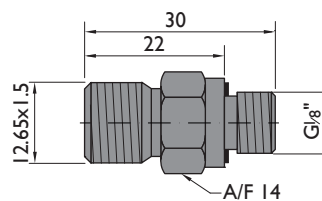

RM-20I

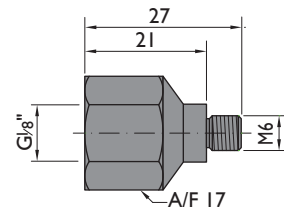

RM-103

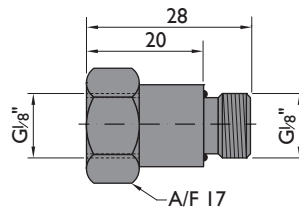

RM-105

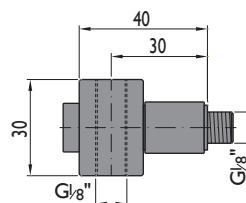

RM-106

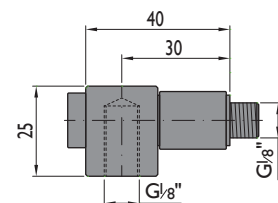

MP-125

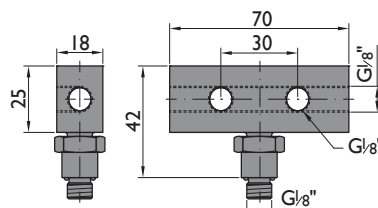

* Includes a non-return valve to keep the pressure on each gas spring individually when removing the hoses.