

Structure for cams width 70 - 100 mm

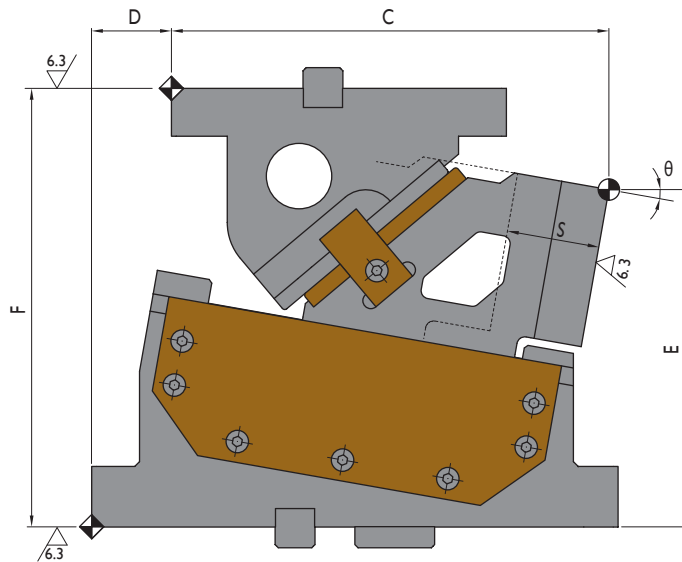

CAM DIAGRAM

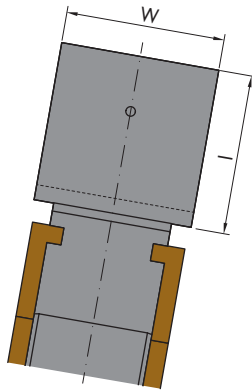
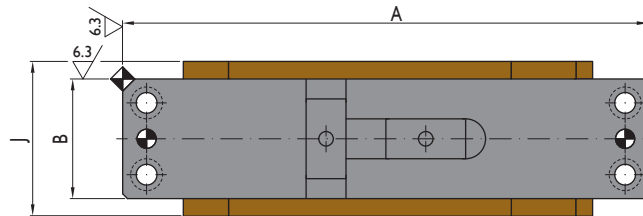
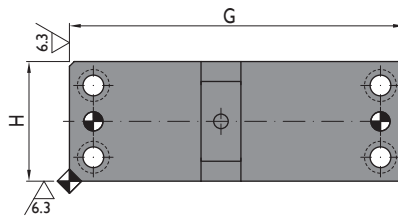
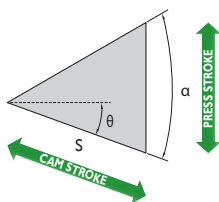

Ordering example: CDCN-W-θ-S
 CDCN-70-05-45

Structure for cams width 210 - 300 mm

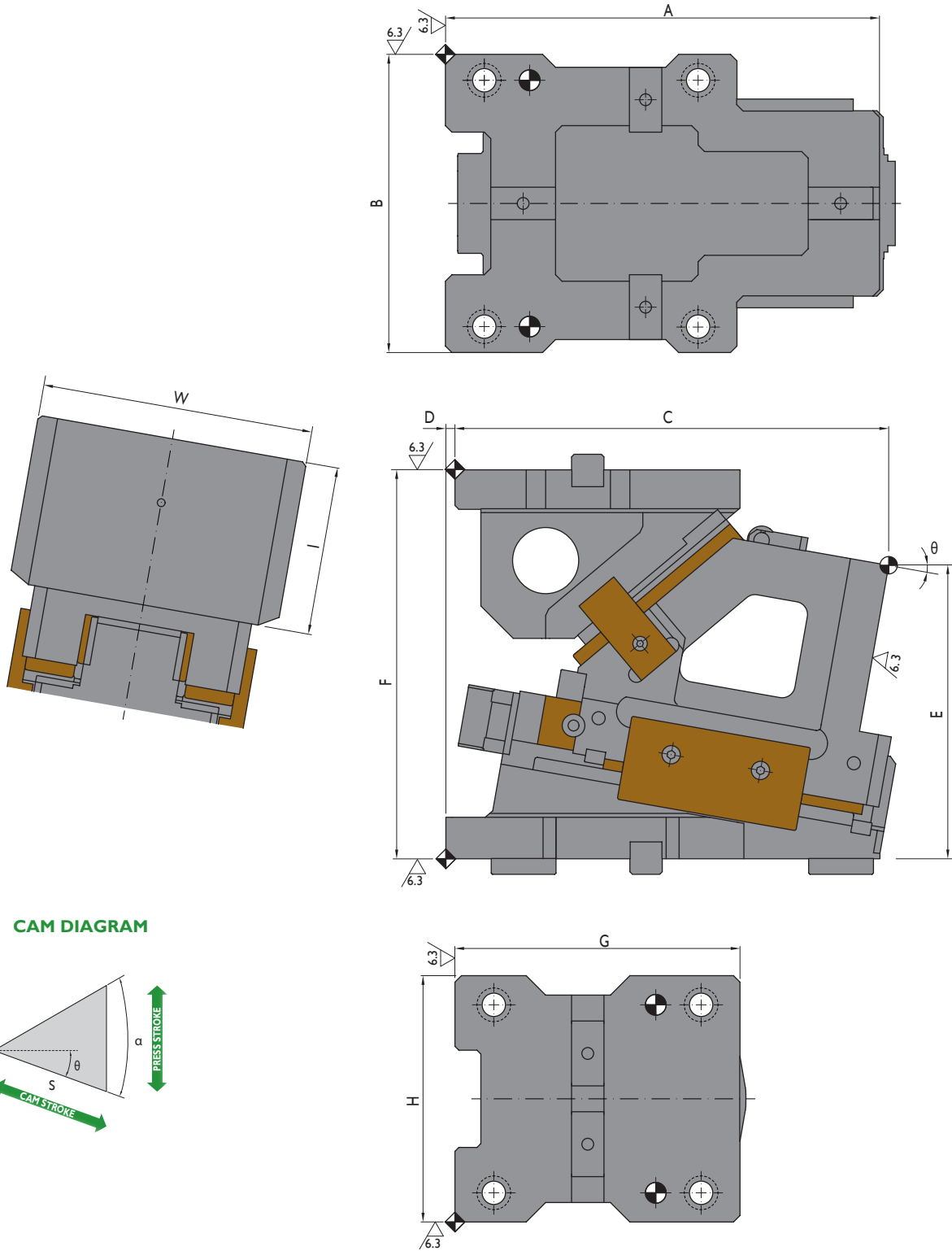

Ordering example: CDCN-W- θ -S
 CDCN-300-15-60

Order No.				Main Features 			General Dimensions										
Model	W mm	θ °	S mm	Working Force tnf 300.000 strokes	Weight kg	Spring Force kgf	A mm	B mm	C mm	D mm	E mm	F mm	G mm	H mm	I mm	J mm	α °
CDCN	70	00	45	7	19.5	280	290	70	252.5	10	195	225	185	70	90	-	50
CDCN	70	05	45	7	20	280	290	70	250.6	25	185.91	225	185	70	90	-	50
CDCN	70	10	45	7	20	280	290	70	253.76	35	176.55	225	185	70	90	-	50
CDCN	70	15	45	7	20	280	290	70	247.47	45	171.91	225	185	70	90	-	50
CDCN	70	20	45	7	21	280	290	70	243.69	57	166.99	225	185	70	90	-	50
CDCN	100	00	55	12	39	560	330	75	278	25	235	275	210	75	100	97	50
CDCN	100	05	55	12	39	560	330	75	271.1	40	225.91	275	210	75	100	97	50
CDCN	100	10	55	12	39	560	330	75	274.26	50	211.55	275	210	75	100	97	50
CDCN	100	15	55	12	39	560	330	75	277.47	60	201.91	275	210	75	100	97	50
CDCN	100	20	55	12	40	560	330	75	270.69	80	191.99	275	210	75	100	97	50
CDCN	210	00	60	20	82	540	335	230	360	-45	250	300	220	190	130	-	50
CDCN	210	05	60	20	82	540	335	230	352.40	-18	240.86	300	220	190	130	-	50
CDCN	210	10	60	20	82	540	335	230	346.86	7	226.33	300	220	190	130	-	50
CDCN	210	15	60	20	82	540	335	230	341.35	22	216.40	300	220	190	130	-	50
CDCN	210	20	60	20	83	540	335	230	330.82	47	206.09	300	220	190	130	-	50
CDCN	300	00	60	37	166	1120	390	350	360	0	325	375	220	270	160	-	50
CDCN	300	05	60	37	166	1120	380	350	360.71	15	300.80	375	220	270	160	-	50
CDCN	300	10	60	37	170	1120	380	350	356.47	35	291.10	375	220	270	160	-	50
CDCN	300	15	60	37	171	1120	380	350	352.23	55	275.89	375	220	270	160	-	50
CDCN	300	20	60	37	171	1120	380	350	347.95	75	260.18	375	220	270	160	-	50