

**CAM DIAGRAM**

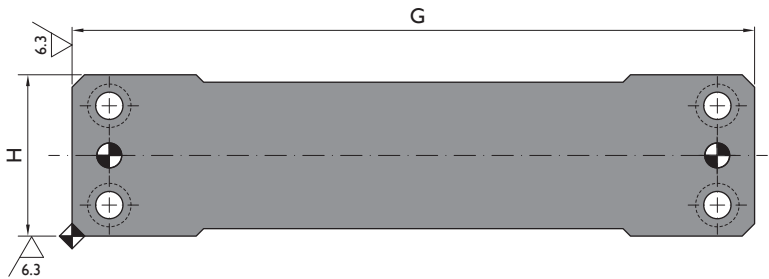
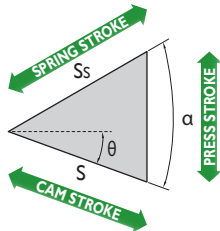

Ordering example: CACT-W-θ  
CACT-65-10

Order No.			Main Features					General Dimensions											
Model	W mm	$\theta$ °	S mm	Working Force tnf		Weight kg	Spring Force kgf	A mm	B mm	C mm	D mm	E mm	F mm	G mm	H mm	I mm	Ss mm	$\alpha$ °	
				1,000,000 strokes	300,000 strokes														
CACT 65 00	65	00	22.5	7	14	18.4	611	165	65	255	95	150.8	230	275	65	90	35	50	
CACT 65 05	65	05	22.6	7	14	18.6	611	165	65	265.68	95	147.71	230	275	65	90	35	55	
CACT 65 10	65	10	27.2	7	14	17.4	611	165	65	256.04	75	143.71	230	275	65	90	35	50	
CACT 65 15	65	15	27.8	7	14	17.5	611	165	65	266.02	75	138.82	230	275	65	90	35	55	
CACT 65 20	65	20	32.3	7	14	16.6	611	165	65	255.53	60	133.07	230	275	65	90	35	50	
CACT 65 25	65	25	33.4	7	14	16.8	611	165	65	264.51	60	126.52	230	275	65	90	35	55	
CACT 65 30	65	30	38	7	14	16.9	611	165	65	252.88	40	119.21	230	290	65	90	35	50	
CACT 65 35	65	35	40.2	7	14	17	611	165	65	260.58	40	111.2	230	290	65	90	35	55	
CACT 65 40	65	40	45	7	14	16.4	611	165	65	242.56	20	107.55	230	290	65	90	35	50	
CACT 65 45	65	45	48.7	7	14	16.6	611	165	65	248.75	20	98.33	230	290	65	90	35	55	
CACT 65 50	65	50	54.5	7	14	15.9	611	165	65	236.28	0	104.02	230	290	65	90	35	50	
CACT 65 55	65	55	61	7	14	16.1	611	165	65	240.78	0	93.86	230	290	65	90	35	55	
CACT 65 60	65	60	70	7	14	16.4	611	165	65	234.5	-10	84.69	230	290	65	90	35	60	
CACT 65 65	65	65	68.5	7	14	18	605	165	65	231.79	-45	83.28	230	290	65	90	29	65	
CACT 65 70	65	70	67.2	7	14	18	598	165	65	228.97	-45	82.11	230	290	65	90	23	70	
CACT 65 75	65	75	69.5	7	14	20	536	165	65	233.82	-45	62.21	230	290	65	90	18	75	