

WEB
↓
CAD

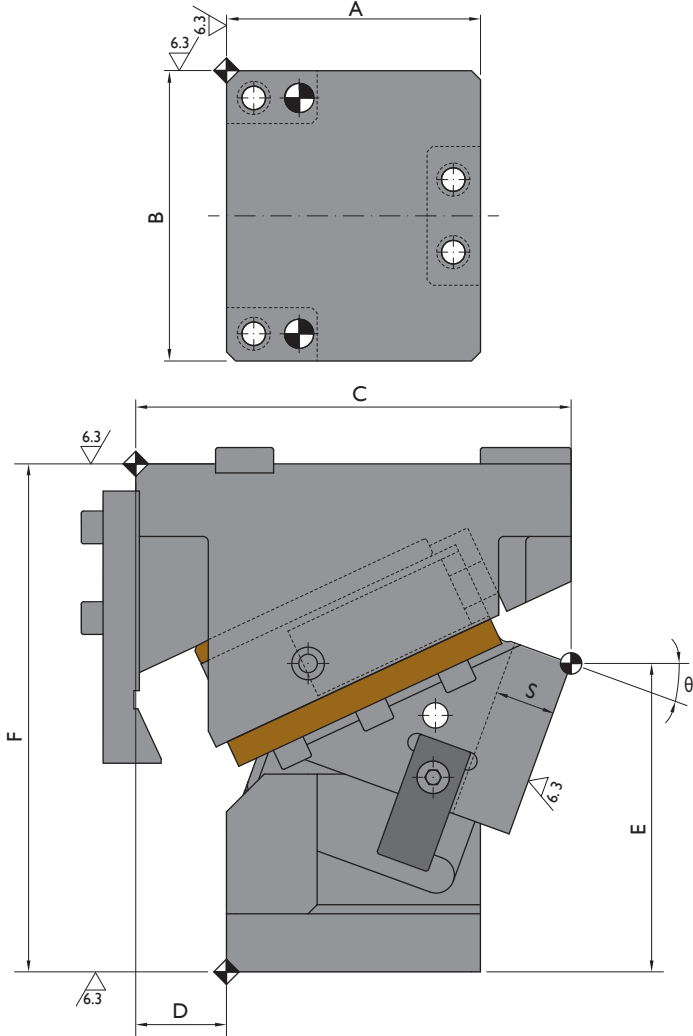

CAM DIAGRAM

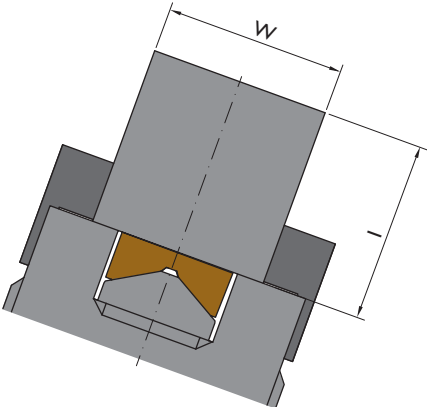
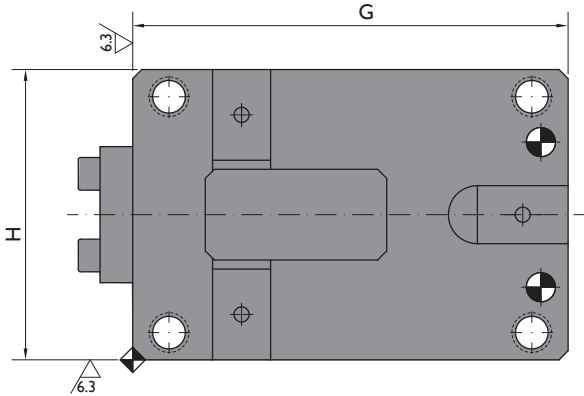
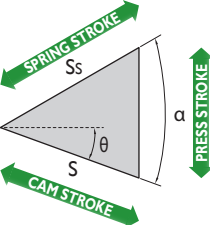

Ordering example: CACK-W- θ
CACK-65-70

Order No.			Main Features					General Dimensions										
Model	W mm	θ °	S mm	Working Force tnf		Weight kg	Spring Force kgf	A mm	B mm	C mm	D mm	E mm	F mm	G mm	H mm	I mm	S _s mm	α °
				1.000.000 strokes	300.000 strokes													
CAACK	65	00	26.9	2	4	20.5	550	80	115	185.94	75	153.43	210	180	115	80	38	45
CAACK	65	05	27	2	4	20.8	550	80	115	193.01	70	153.43	210	180	115	90	38	50
CAACK	65	10	31.6	2	4	20.3	550	80	115	196.8	70	142.42	210	180	115	80	38	45
CAACK	65	15	32.2	2	4	20.6	550	80	115	203.77	67	141.19	210	180	115	90	38	50
CAACK	65	20	33.8	2	4	19.1	550	80	115	198.1	60	135.69	210	180	115	80	35	45
CAACK	65	25	35	2	4	19.4	550	80	115	204.75	55	133.27	210	180	115	90	35	50
CAACK	65	30	33.5	2	4	18.7	550	80	115	193.63	50	120.48	210	180	115	80	30	45
CAACK	65	35	35.4	2	4	19	550	80	115	199.76	45	116.94	210	180	115	90	30	50
CAACK	65	40	42.9	2	4	17.9	550	80	115	188.72	40	110.38	210	180	115	80	33	45
CAACK	65	45	46.5	2	4	18.1	550	80	115	194.13	34	105.84	210	180	115	90	33	50
CAACK	65	50	54.5	2	4	17.8	550	80	115	190	30	100	210	180	115	90	35	50
CAACK	65	55	43.6	2	4	18.8	530	80	115	190	20	95	210	180	115	100	25	55
CAACK	65	60	50	2	4	18.3	530	80	115	190	20	95	210	180	115	100	25	60
CAACK	65	65	47.3	2	4	19.5	530	80	115	190	0	80	210	180	115	110	20	65
CAACK	65	70	58.5	2	4	19.4	530	80	115	190	0	80	210	180	115	110	20	70
CAACK	100	00	28.3	4	9	49.4	1120	140	160	240	80	195	280	240	160	100	40	45
CAACK	100	05	28.4	4	9	50.2	1120	140	160	236.89	60	206.18	280	240	160	140	40	50
CAACK	100	10	33.3	4	9	47.3	1120	140	160	240	60	190	280	240	160	100	40	45
CAACK	100	15	33.9	4	9	49.5	1100	140	160	254.35	60	198.49	280	240	160	140	40	50
CAACK	100	20	30.9	4	9	47.2	1100	140	160	240	50	170	280	240	160	100	32	45
CAACK	100	25	32	4	9	48.9	1100	140	160	253.26	50	177.4	280	240	160	140	32	50
CAACK	100	30	33.5	4	9	46.5	1100	130	160	240	30	170	280	240	160	120	30	45
CAACK	100	35	35.4	4	9	47.8	1100	130	160	252.34	30	170.31	280	240	160	140	30	50
CAACK	100	40	39	4	9	47.8	1100	120	160	240	30	165	280	240	160	120	30	45
CAACK	100	45	42.3	4	9	44.1	1100	120	160	247.41	30	165.32	280	240	160	140	30	50
CAACK	100	50	46.7	4	9	43.6	1100	120	160	240	10	160	280	240	160	140	30	50
CAACK	100	55	52.3	4	9	46.4	1100	120	160	240	0	135	280	240	160	140	30	55
CAACK	100	60	60	4	9	44.9	1100	110	160	240	0	135	280	240	160	140	30	60
CAACK	100	65	47.3	4	9	45.4	1060	110	160	240	0	135	280	240	160	140	20	65
CAACK	100	70	58.5	4	9	44.2	1060	110	160	240	0	135	280	240	160	140	20	70
CAACK	200	00	28.3	9	19	82.9	2240	110	260	240	80	195	280	240	260	100	40	45
CAACK	200	05	28.4	9	19	83.7	2240	110	260	236.82	60	201.16	280	240	260	130	40	50
CAACK	200	10	33.3	9	19	77.1	2240	110	260	240	60	190	280	240	260	100	40	45
CAACK	200	15	33.9	9	19	81.9	2200	110	260	254.35	60	198.49	280	240	260	130	40	50
CAACK	200	20	30.9	9	19	77.5	2200	110	260	240	50	170	280	240	260	100	32	45
CAACK	200	25	32	9	19	81.5	2200	110	260	253.27	50	177.4	280	240	260	130	32	50
CAACK	200	30	33.5	9	19	78.4	2200	110	260	240	30	170	280	240	260	120	30	45
CAACK	200	35	35.4	9	19	82.3	2200	110	260	252.34	30	170.31	280	240	260	140	30	50
CAACK	200	40	39	9	19	72.8	2200	110	260	240	30	165	280	240	260	120	30	45
CAACK	200	45	42.3	9	19	76.1	2200	110	260	247.41	30	165.32	280	240	260	140	30	50
CAACK	200	50	46.7	9	19	73	2200	110	260	240	10	160	280	240	260	140	30	50
CAACK	200	55	52.3	9	19	80	2200	110	260	240	0	135	280	240	260	140	30	55
CAACK	200	60	60	9	19	75.3	2200	110	260	240	0	135	280	240	260	140	30	60
CAACK	200	65	47.3	9	19	78.6	2120	110	260	240	0	135	280	240	260	140	20	65
CAACK	200	70	58.5	9	19	73.6	2120	110	260	240	0	135	280	240	260	140	20	70